

An abstract, flowing red architectural form, possibly a sculpture or a modern building facade, is visible on the left side of the slide. It has a curved, ribbon-like appearance with some internal structural details visible.

Art in Architecture

U.S. General Services Administration

The images contained herein are used educationally within the confines of this presentation pursuant to Title 17 USC Sections 110 (1) and 110 (2)(c)(ii), and is transmitted electronically to attendees for their sole educational, personal, and noncommercial use.



Alexander Calder, *Flamingo*, 1974
painted steel, 53 x 24 x 60 feet
John C. Kluczynski Federal Building, Chicago.

GSA Art in Architecture

Funding = 0.5% of Estimated Construction Cost (ECC)

\$100,000,000 ECC = \$500,000 art commission

GSA Art in Architecture panels:

1. GSA Art Peer (appointed by PBS Commissioner)
2. Art professional from project city, state or region
3. Federal client representative
4. Community representative
5. A/E lead designer
6. Regional Commissioner's representative
7. Art in Architecture Program representative



John J. Moakley U.S. Courthouse, Boston, Massachusetts.
lead designer: Harry Cobb / Pei Cobb Freed & Partners.

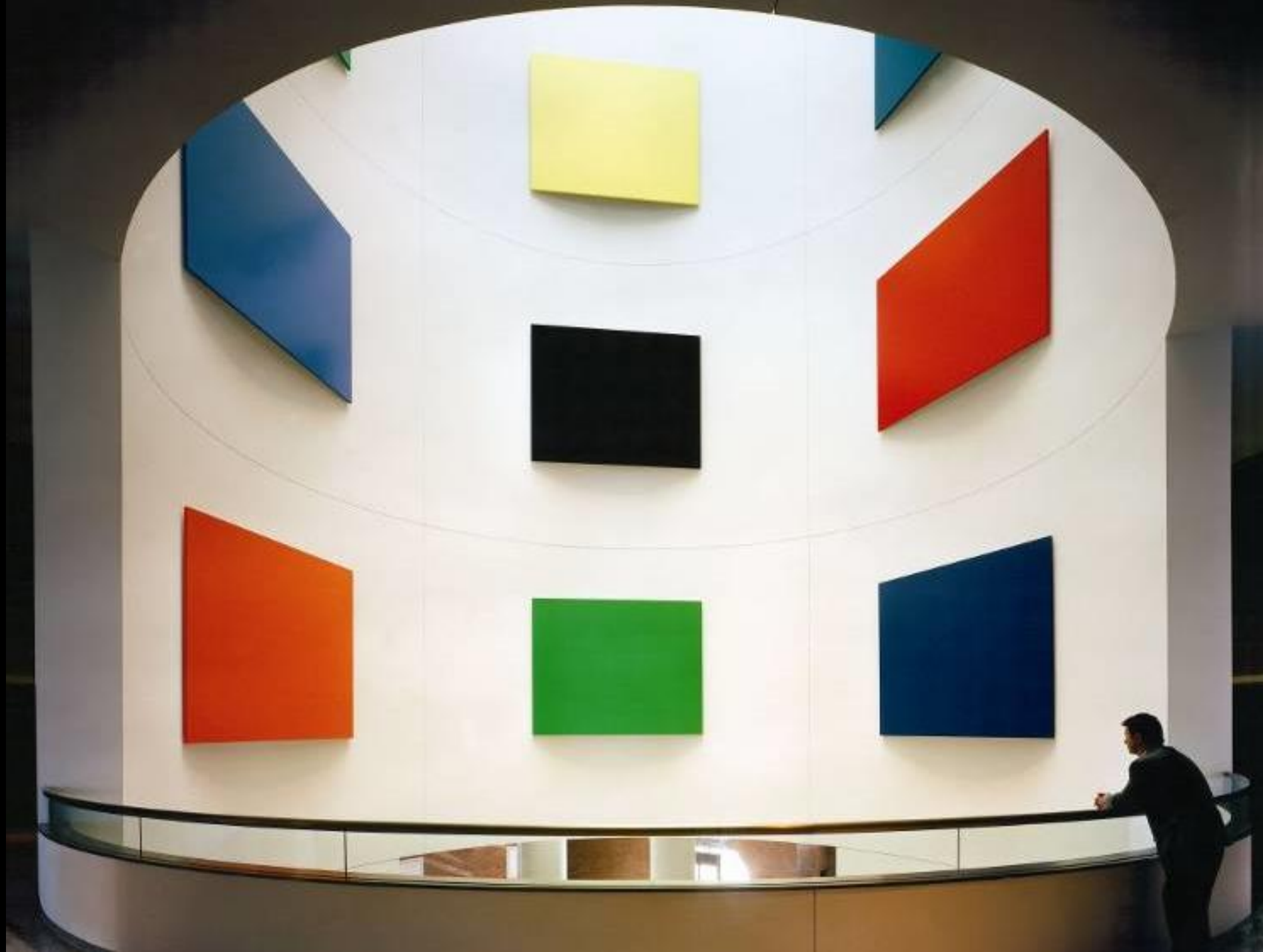

Ellsworth Kelly, *The Boston Panels* (detail), 1998
painted aluminum, each 11 x 13 ½ feet
John J. Moakley U.S. Courthouse, Boston, Mass.



Ellsworth Kelly, *The Boston Panels* (detail), 1998
painted aluminum, each 7 x 11 feet
John J. Moakley U.S. Courthouse, Boston, Mass.



Leo Villareal, *Sky*, 2010, LEDs, custom electronics and diffusion screen, 11 x 30 feet
U.S. Courthouse, El Paso, Texas.



Leo Villareal, *Sky*, 2010, LEDs, custom electronics and diffusion screen, 11 x 30 feet
U.S. Courthouse, El Paso, Texas.



Caleb O'Connor, *Tuscaloosa Murals* (detail), 2011
oil on canvas, 16 panels, each 12 x 9 feet, U.S. Courthouse, Tuscaloosa, Alabama.



Odili Donald Odita, *Infinite Horizon* (detail), 2013
acrylic paint on wood panels,
George C. Young Federal Building and U.S. Courthouse,
Orlando, Florida.

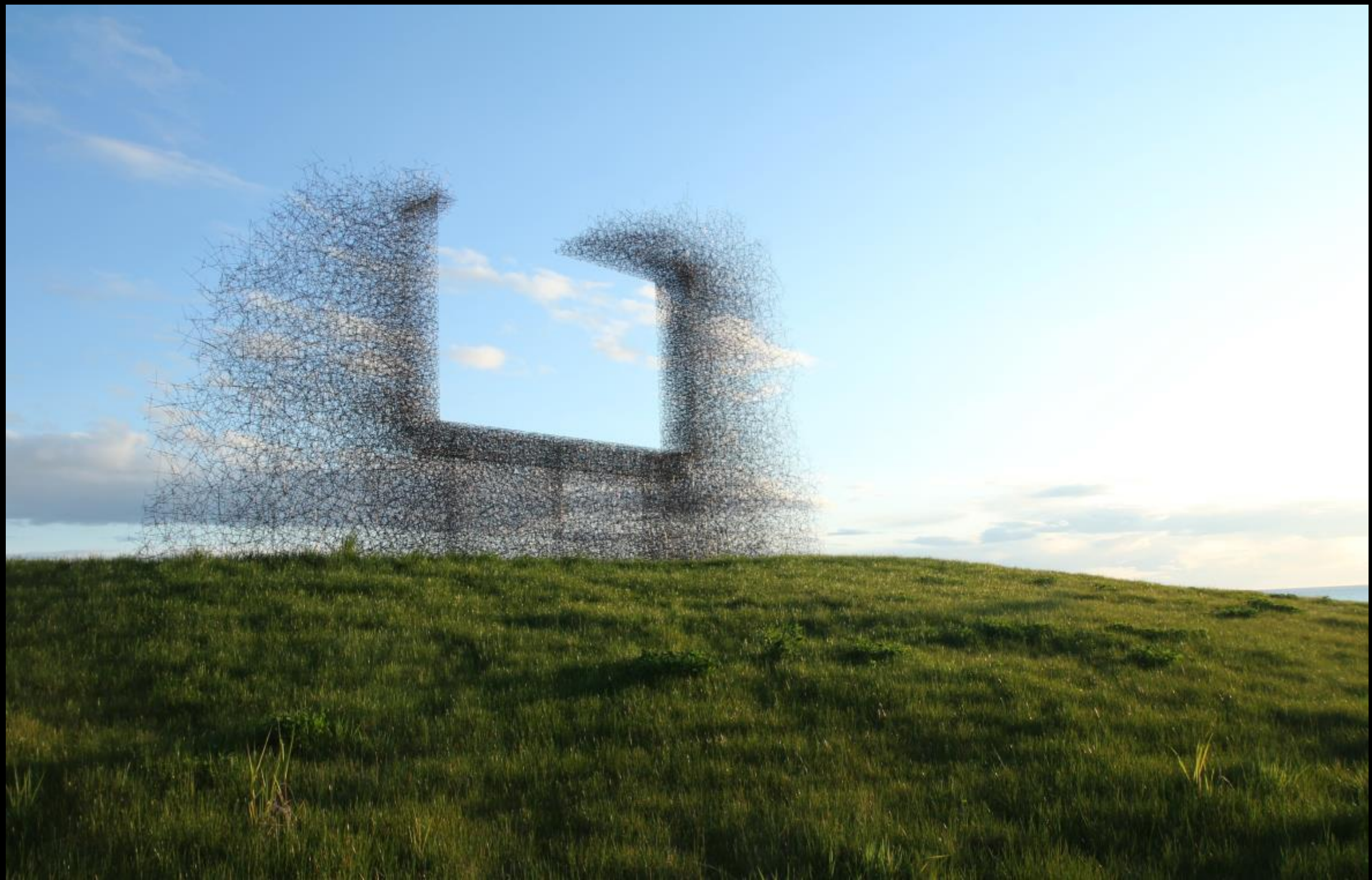

Lead Pencil Studio, *Non Sign II*, 2010
U.S. Land Port of Entry, Blaine, Washington.



Nina Katchadourian
Grand State Of Maine, 2013
Land Port of Entry, Van Buren, Maine



Meejin Yoon
Double Horizon, 2014
San Ysidro Land Port of Entry, California



Meejin Yoon
Double Horizon, 2014
San Ysidro Land Port of Entry, California



Doug Hyde, (untitled), 1999
Pete V. Domenici U.S. Courthouse
Albuquerque, New Mexico

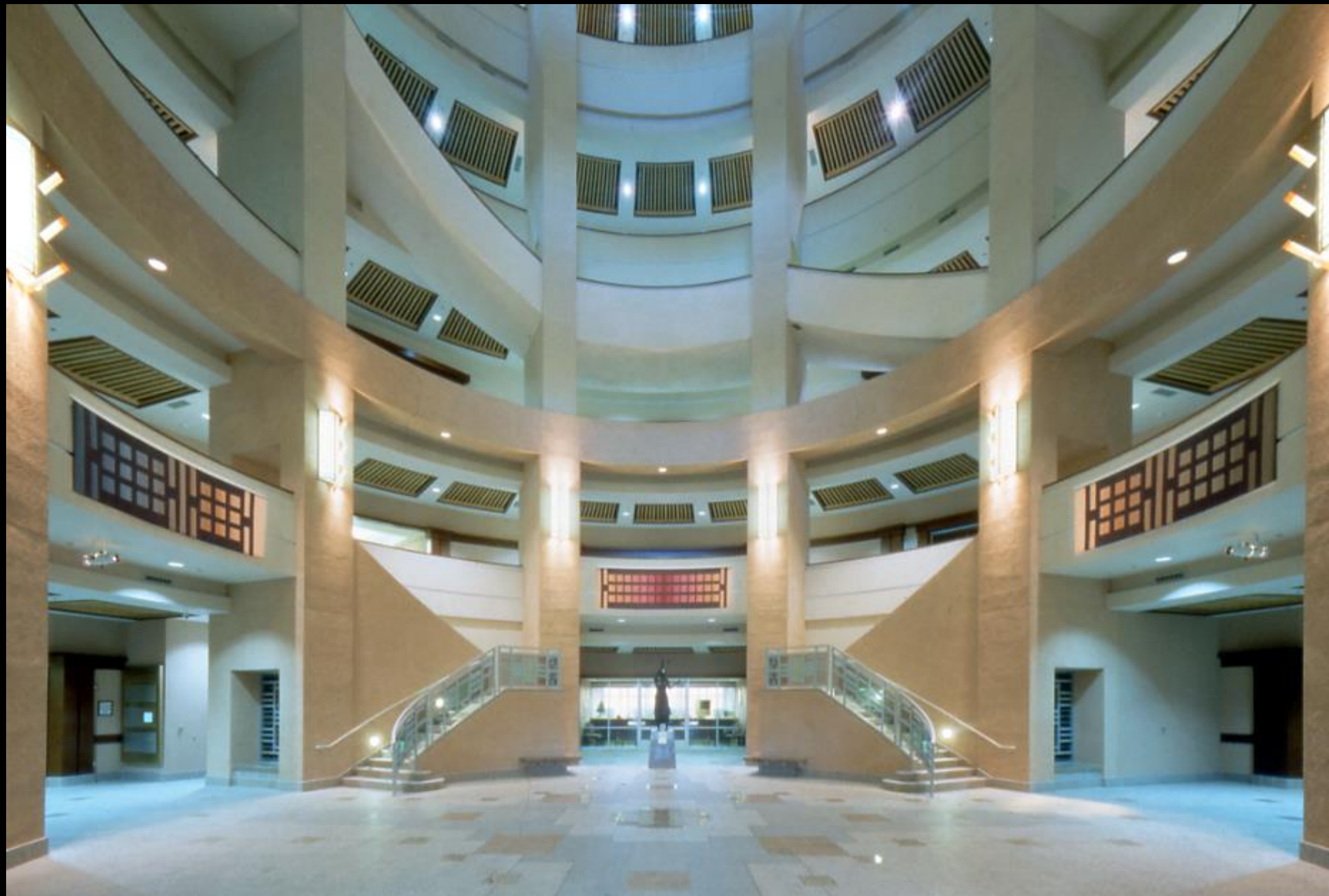

Rebecca Bluestone, *Four Corners Triptych*, 1999
Pete V. Domenici U.S. Courthouse
Albuquerque, New Mexico



Michael A. Naranjo, *Justice*, 1995
Pete V. Domenici U.S. Courthouse
Albuquerque, New Mexico



Larry Kirkland, *Obelisk*, 2010 and *Portal*, 2010
Dan McCleary, *American Jury*, 2010
U.S. Courthouse, Las Cruces, New Mexico

To participate in GSA Art in Architecture:

1. Join GSA National Artist Registry
information available at www.gsa.gov/artinarchitecture
2. Update your information and images as necessary

NOTE: Artists do not need apply for individual projects
Only artists short-listed for a commission are contacted

An abstract sculpture made of red, curved, ribbon-like material, forming a series of overlapping loops and curves, set against a black background.

Art in Architecture and Fine Arts

U.S. General Services Administration

www.gsa.gov/fa

www.gsa.gov/artinarchitecture